

- FP** Faculty Parking
- SP** Staff Parking
- VP** Visitor Parking
- PP** Platform Party Parking
- VIP** VIP Parking
- ADA** ADA Parking

If you need assistance with ADA parking, please call (603) 899-4162 or email polloma@franklinpierce.edu.

Two Way Roads



2024 Franklin Pierce University Commencement

Mountain Road
**Morning
ENTRANCE**

**Afternoon
EXIT**

University Drive

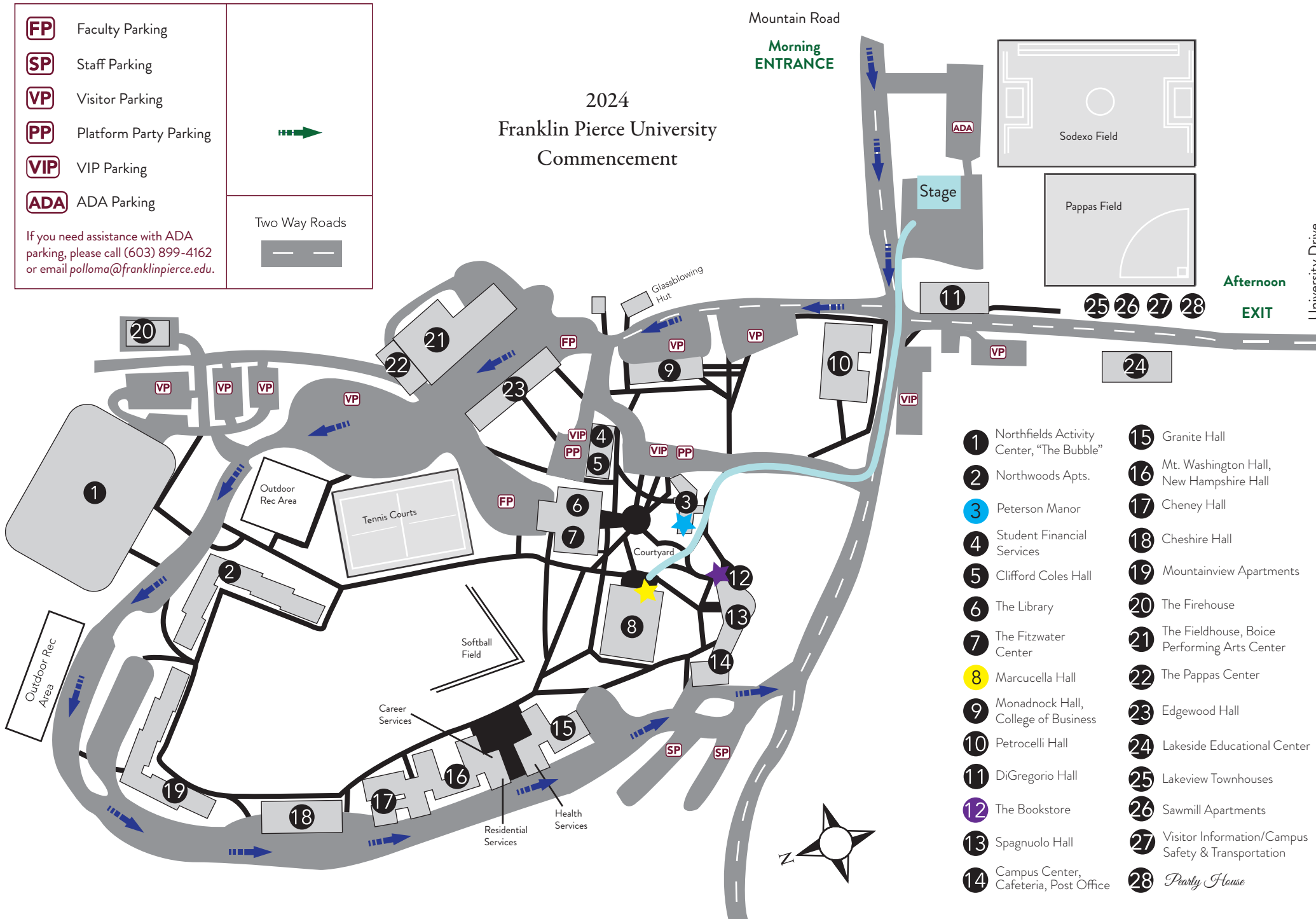

- | | |
|--|--|
| 1 Northfields Activity Center, "The Bubble" | 15 Granite Hall |
| 2 Northwoods Apts. | 16 Mt. Washington Hall, New Hampshire Hall |
| 3 Peterson Manor | 17 Cheney Hall |
| 4 Student Financial Services | 18 Cheshire Hall |
| 5 Clifford Coles Hall | 19 Mountainview Apartments |
| 6 The Library | 20 The Firehouse |
| 7 The Fitzwater Center | 21 The Fieldhouse, Boice Performing Arts Center |
| 8 Marcuccella Hall | 22 The Pappas Center |
| 9 Monadnock Hall, College of Business | 23 Edgewood Hall |
| 10 Petrocelli Hall | 24 Lakeside Educational Center |
| 11 DiGregorio Hall | 25 Lakeview Townhouses |
| 12 The Bookstore | 26 Sawmill Apartments |
| 13 Spagnuolo Hall | 27 Visitor Information/Campus Safety & Transportation |
| 14 Campus Center, Cafeteria, Post Office | 28 Party House |