

2023 ACADEMIC SHOWCASE SCHEDULE

Tuesday, April 18
9 a.m. - 4 p.m.



www.franklinpierce.edu/academicshowcase

Franklin Pierce University welcomes you to the
2023 Academic Showcase

WELCOME

Dr. Kim Mooney '83, President

Franklin Pierce University
9 a.m. | Spagnuolo Hall

SCHEDULE OF EVENTS

Poster Session One | Students and Faculty

9:15 - 10:30 a.m. | Spagnuolo Hall

Student, Faculty, and Staff Presentations

10 a.m. - 12 p.m. | Various Locations

Jazz and Pep Band Performances

12 p.m. | Library Courtyard (*Cheney Hall - rain location*)

Poster Session Two | Students

1 - 2 p.m. | Spagnuolo Hall

Student, Faculty, and Staff Presentations

1 - 3 p.m. | Various Locations

S'mores

3 p.m. | Library Cafe Patio

Franklin Pierce Diamond Steppers Performance

3 p.m. | Cheney Hall

Maple Syrup Label Competition

9 a.m. - 4 p.m. | DiPietro Library

Virtual Presentations

www.franklinperce.edu/academicshowcase

SPAGNUOLO HALL, EMILY FLINT CAMPUS CENTER

| TIME | TITLE | PRESENTER |
|-------------------|--|--|
| 9 - 9:15 a.m. | WELCOME by Dr. Kim Mooney '83, <i>President Franklin Pierce University</i> | |
| 9:15 - 10:30 a.m. | Poster Session One: Students and Faculty | <p>Skylynn Anderson '25, Karen Andreozzi '23, Bianca Bakken '24, Linda Barriere '24, Justin Blair '23, Brogan Bonsaint '24, Briahna Bouchard '25, Landon Bromley '24, Miranda Carreiro '24, Amber Casey '23, Brandon Cross '23, Reece Diener '23, Patricia Egan '24, Sydney Fringer '23, Abigail Gamberdella '23, Christian Garcia '26, Marissa Goncalves '24, Joshua Hughes '23, Cassidy Jones '23, Brianna Kelley '24, Olivia Krisak '24, Salvatore Lando '24, Emma Longmire '23, Britney Loyd '23, Connor McCormack '24, Cailey McLaughlin '25, Gabrielle Oswald '23, Andrew Philbin '23, Mikayla Piascik '24, Abigayle Poirot '23, Emilie Prive '23, Rachel Ranelli '23, Isabel Rasmussen '23, Morgan Saletnik '25, Aliyah Sonnier '23, David Talbot '25, Marguerite Tremblay '24, Forrest Veilleux '24, Karl Vernet '24, Morgan Wilson '24, Leslie Buddington, <i>Assistant Professor of Psychology</i>, Hannah Everidge, <i>DEI Graduate Assistant</i>, Melissa Robbins, <i>Library staff</i>, and Alin Rus, <i>Lecturer</i></p> |
| 1 - 2 p.m. | Poster Session Two: All Class of 2026 unless otherwise designated | <p>Kusum Aryal, Christian Campbell '24, Lynsey Chabot, Khloe Crossman, Kailee Fournier, Morgan Hellman, Jill Hertl, Katie Hickey, Amy Jones, Olivia Jones, Jonathan Labrecque, Jack Lee, Taylor Maher, Madison Martel, Adam Mentzer, Dierdre Mullin, Landon McClure, Douglas McGuire, Erin McIlroy '25, Lindsey Price, Megan Raymond '25, Abby Rice, Grace Rich, Marisa Salinas, Allison Shalek, Mackenzie Sirowich, Coleby Vasoll, Christy Vernon, Olivia Wilkins, and Cameron Woodhams</p> |

FITZWATER 101, MARLIN FITZWATER CENTER FOR COMMUNICATION

| TIME | TITLE | PRESENTER | FORMAT |
|----------------------------|---|--|--------------|
| 10:30 - 11 a.m. | Massachusetts Air Pollution Trends Since 2019 | Morgan Schmutzler '23 | Presentation |
| 11:05 - 11:35 a.m. | Religion in Society | Rachel Swenson '23 | Presentation |
| 11:40 a.m. - 12:10 p.m. | A Semester on the Road to Santiago: The Long-term Impacts of Walking the Camino de Santiago with a Family-like Study Abroad Group | Doug Challenger, <i>Professor of Sociology</i> | Presentation |
| 1 - 1:30 p.m. | The Global Water Crisis | Catherine Koning, <i>Professor of Environmental Science</i> | Presentation |
| 1:35 - 2:05p.m. | Discovery of a Bacteriophage from Brown Bat Guano | Forrest Veilleux '24 | Presentation |

FITZWATER 102, MARLIN FITZWATER CENTER FOR COMMUNICATION

| TIME | TITLE | PRESENTER | FORMAT |
|--------------------|---|--|--------------|
| 10 - 10:30 a.m. | A Case Study in University School Collaboration | Joan Swanson, <i>Associate Professor and Director of the School of Education</i> Rueben Duncan, <i>School Superintendent</i> | Presentation |
| 10:35 - 11:05 a.m. | Early Modern Sexuality in the Archives and on Stage | Jess Landis, <i>Associate Professor of English and Composition</i> | Presentation |

FITZWATER STUDIO, MARLIN FITZWATER CENTER FOR COMMUNICATION

| TIME | TITLE | PRESENTER | FORMAT |
|----------------------|--|--|--|
| 11:30 a.m. - 12 p.m. | <p>“Walk for Ukraine” Joining Caitlin Agnew on stage will be Ukrainian student Katya Karpunina, who is completing her studies at Keene State. She will talk with Agnew and the studio audience about living through the start of the Russian invasion.</p> | Caitlin Agnew '23 | <p>Screening</p>  |
| 2 - 2:30 p.m. | <p>Innocent or Guilty - A discussion about the RaDonda Vaught case and its implications for nurses</p> | Diana Connors '23, Sophie Allen '23 | <p>Screening</p>  |

MARCUCELLA 102, MARCUCELLA HALL

| TIME | TITLE | PRESENTER | FORMAT |
|--------------------|---|--|--|
| 10 - 10:30 a.m. | The Prosecution of Child Sex Offenses | Oaklee Lamberto '23 | Presentation |
| 10:35 - 11:05 a.m. | Immigrant Identity since the 1900s | Oaklee Lamberto '23 | Presentation |
| 1 - 1:30 p.m. | Sinead O'Connor's "Famine": Art Meets History | Paul Jenkins, <i>University Librarian</i> Mary Kelly, <i>Professor of History</i> | Presentation |
| 1:35 - 3 p.m. | Designing A Sustainable Campus | Joshua Cline, <i>Adjunct Instructor</i> | Charette (<i>planning activity session</i>) |

MARULLI WELCOME CENTER, PETERSON MANOR

| TIME | TITLE | PRESENTER | FORMAT |
|-----------------|---|--|-------------|
| 10:30 - 11 a.m. | "By Her Hand" | Donna Decker, <i>Professor of English</i> | Performance |
| 1 - 1:30 p.m. | Beyond The Page: Artistic Representations of Literary Texts | Kaylee Geheb '23, Jenna Parent '25, Simeon Mills '25 | Performance |

OTHER LOCATIONS

| TIME | PRESENTATION | LOCATION |
|-----------------|--|---|
| 9 a.m. - 4 p.m. | Maple Syrup Label Competition | DiPietro Library |
| 9 a.m. - 4 p.m. | Student Watercolors Painting Exhibition Andie Anderson '26, Connor Nordman '24, Patricia Egan '24, Emilie Fox '25, Heather Pilling '24, Amiah Johnson '25 | DiPietro Library |
| 12 - 1 p.m. | Jazz and Pep Band Performances | Library Courtyard (Cheney Hall- rain location) |
| 2:30 - 3 p.m. | Randy Peralta '25, Musical Performance | Cheney Hall |
| 3 - 3:10 p.m | Presentation of Faculty Citation in Honor of Professor Douglas A. Ley, 1958 - 2021. | Library Courtyard (Cheney Hall- rain location) |
| 3 - 3:30 p.m. | Jumanji: Diamond Steppers Performance | Cheney Hall |
| 3 - 4 p.m | S'Mores | Library Café Patio |

| | |
|--|-------------------------|
| | Roadways / Parking Lots |
| | Student Walkways |
| | Faculty/Staff Parking |
| | Student Parking |
| | Visitor Parking |

| | |
|----------------|---------------|
| Map Key | |
| | One Way Roads |
| | Two Way Roads |

***CAUTION** Campus roadways are One Way

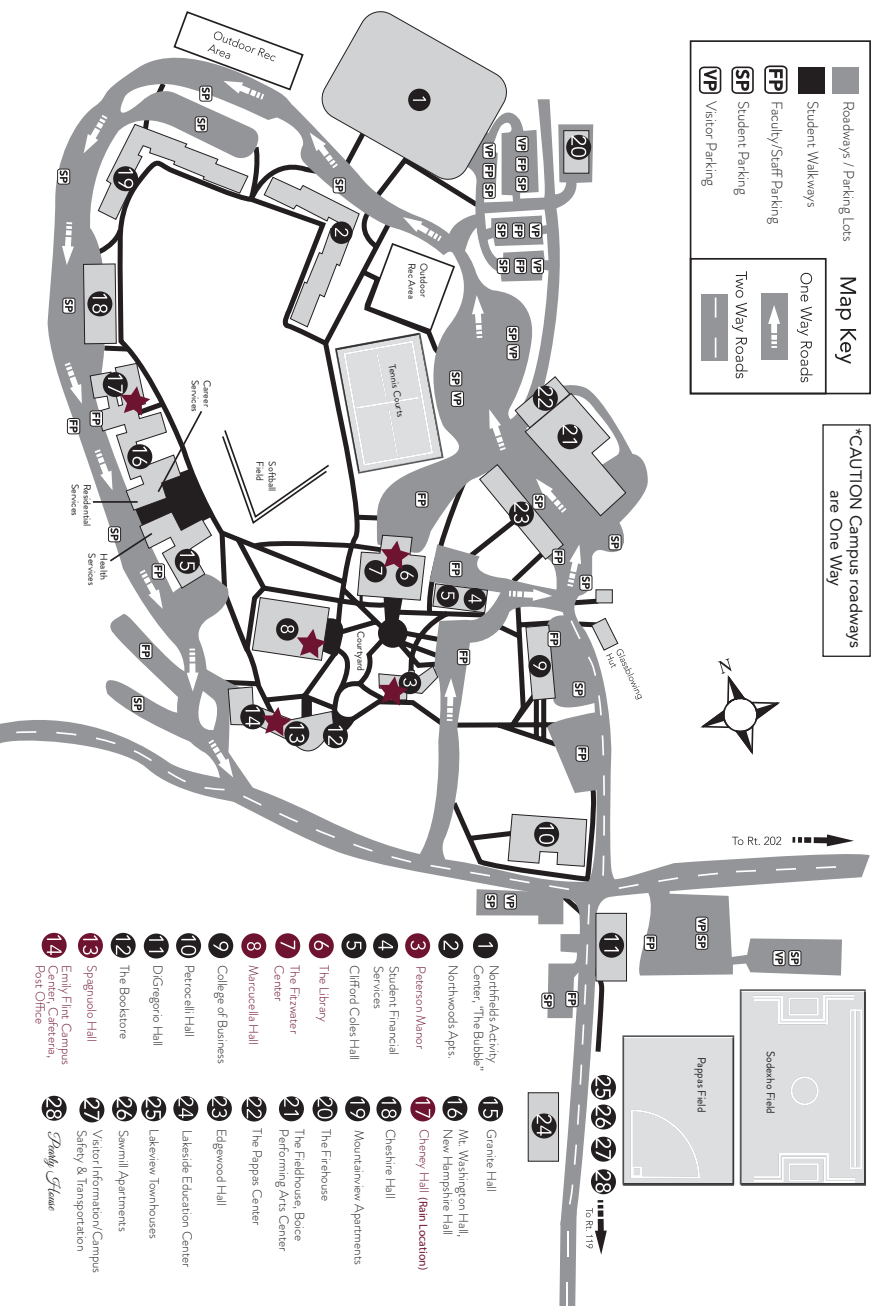

- 1 Northfields Activity Center, "The Bubble"
- 2 Northwoods Apts.
- 3 Pearson Manor
- 4 Student Financial Services
- 5 Clifford Coles Hall
- 6 The Library
- 7 The Fitzwater Center
- 8 Mercetella Hall
- 9 College of Business
- 10 Peacock Hall
- 11 D'Gregorio Hall
- 12 The Bookstore
- 13 Spagnuolo Hall
- 14 Emily/Frank Campus Center, Cafeteria, Post Office
- 15 Granite Hall
- 16 Mt. Washington Hall
- 17 Cheney Hall (Ban location)
- 18 Cheshire Hall
- 19 Mountarnew Apartments
- 20 The Freehouse
- 21 The Freshouts, Boice Performing Arts Center
- 22 The Pappas Center
- 23 Edgewood Hall
- 24 Lakeside Education Center
- 25 Lakereview Townhouses
- 26 Sawmill Apartments
- 27 Visitor Information/Campus Safety & Transportation
- 28 *Study Skans*